



MODEL Homogenizer HA53

MODEL	MAX. POWER		PRESSURE bar						CAPACITY l/h
	kW		100	180	200	250	300	400	
HA53	400		90.000	72.000	65.000	52.000	43.000	32.000	24.600

*Values referring to machines with fixed capacity

**Values referring to products with a max viscosity of 500Cp

TECHNICAL DATA

Plunger number	5
Stroke (mm)	140
Weight (kg)	10.000
Water consumption (l/h)	300
Lubrication oil quantity (kg)	120
Connection product inlet/outlet	Flange to weld $\varnothing e115 \varnothing i110 / \varnothing e52 \varnothing i46$
Max. installed power (kW)	400

Design according to MACHINE DIRECTIVES and the HARMONIZED EUROPEAN STANDARD in force.



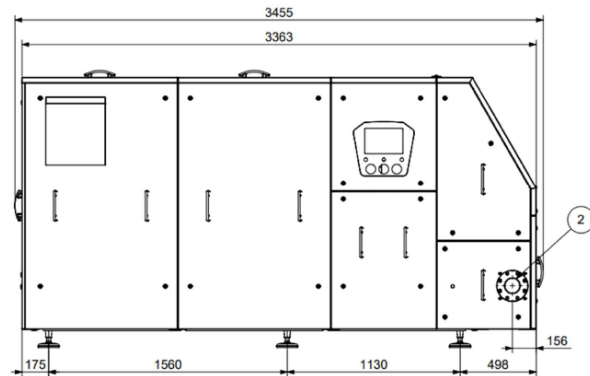
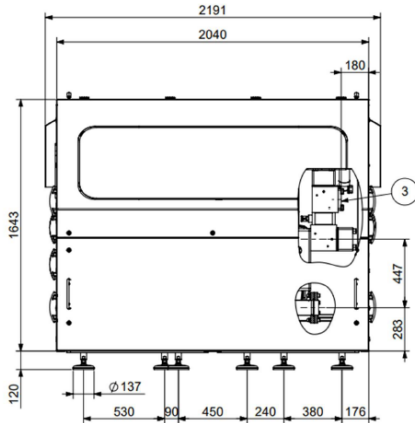

FEATURES

Liquid End: Forged block made from Duplex SAF2205, 5 plungers made from A316 with HVOF Chromium Carbide jet coating

Homogenizing group:

- Hydro-pneumatic adjustment of the pressure for a great stability
- Stellite™ Homogenizing valves

Conical valve seats and poppet/ball valves made from Stellite™

Digital pressure transmitter 4-20 mA with ceramic membrane

Overpressure valve, flow switch alarm on water circuit

Drive Unit:

- Forced lubrication system with pressure switch
- Cast iron crankcase with supporting roller bearings
- Nitridized crankshaft
- Double stage transmission system with internal gear reducer with belts and pulleys

Terminal box and control panel for local/remote control

Easy opening panels

Friendly maintenance of the liquid end

Sound-proof design

MAIN OPTIONS

Second stage homogenizing group

Forged block made from Super Duplex SAF2507

Aseptic execution

- Sterile water generator by means of condensed steam generator
- Patent pending sterile water generator by means of microfiltration

Design suitable with: 3A, EHEDG or PHARMA

- Low roughness and electropolished wetted parts
- Certification manual for cGMP

Standard or Sharp Edge Homogenizing valve with different geometries, materials availability:

- Tungsten Carbide
- Ceramics
- High efficiency patented homogenizing valve "Margherita"

Seat valves made of Tungsten Carbide

Explosion proof design

Pumping plungers availability:

- Integral Ceramics

Electric power board:

- For Fixed or Variable capacity
- Remote Control by 4-20 mA signal
- Fully Automatic pressure control by means of PLC

Inlet and outlet connections:

- DIN 11851, Tri-clamp, SMS
- High pressure outlet
- Option upon request

Vibration and temperature monitoring and alarm

